



Forest Land Resource Consultants, LLC

Consulting Forestry

P.O. Box 7 • West End, NC 27376

(910) 673-0001 Office • (910) 673-3233 Fax • www.forestlandrc.com

INVITATION TO BID ON STANDING TIMBER

Owned by

“Terry Parrott”

Moore County, NC

20 wooded acres, more or less

SALE DATE: 12:00 P.M. – 04/27/2010

Timber Volumes

<u>Product</u>	<u>Volume</u>
Pine Sawtimber	133,000 bf
Pine Pulpwood	140 tons
Red Oak	6,000 bf
Yellow Poplar Logs	21,000 bf
White Oak	11,000 bf
Sweetgum Logs	8,000 bf
Hardwood Blend	496 tons

A timber cruise using tenth acre fixed plots was performed to determine the timber volumes; however, timber volumes are given for information only and are not guaranteed. Cruise lines were spaced 2 chains apart and 2 chains between plots. Acres were determined using a GPS mobile mapping device and a beacon using DGPS correction.

Tract Location

This tract is located near Carthage, NC off Deese Road, in Moore County. Refer to the attached maps for better detail.

Description of Timber & Land

All merchantable timber of every sort and kind contained within the designated sale area is offered for sale on a clear-cut basis. The timber consists of a mixture of loblolly pine, longleaf pine, red and white oak, poplar, maple, hickory, and gum. The boundary for this sale have been flagged with Pink-Glo ribbon and painted with pink and orange paint. Painted sale boundary trees are not to be harvested. The SMZ have not been painted. Within the SMZ all pine species and hardwood measuring 16” or larger at DBH may be harvested.

Walter E. Thomas, RF: Registered Forester #409 • Broker #47789 • walter@forestlandrc.com

Matthew L. Wimberly, RF, ACF: Registered Forester #1407 • Broker #254183 • Certified Burner #566 • wimberly@forestlandrc.com

Land Sales & Acquisitions, Forest Management, Timber Investment Analysis, Timber Marketing, Timber Appraisals,
Present Use Plans, GIS/GPS Mapping, Prescribed Burning, Casualty and Non-casualty Losses

Access

Access for logging can be initiated from Deese Road. Temporary access has been granted by the adjoining landowner for the duration of the timber deed. The location of logging deck will be in coordination with Forest Land Resource Consultants and the Owner. Refer to the attached map for location of existing roads.

Bids

All bids for this sale will be received on a “**lump sum basis only**”. Bids will be accepted and disclosed at **12:00 P.M. Tuesday, April 27, 2010** in my office in Seven Lakes. Please contact our office for directions. All interested buyers who would like to submit a bid in person are to meet at the office on the day of the sale. If you cannot be present for the sale, you have until 11:00 a.m. the same day to place your bid by mail, fax (910) 673-3233, office (910) 673-0001 or by cell phone (910) 639-0124.

The owner reserves forty-eight (48) hours to determine the acceptance or denial of any or all bids.

Conditions of Sale

- 1) The Buyer will have twenty-four (24) months from the date of execution of the timber deed to cut and remove the timber.
- 2) No trees, laps, limbs, or other debris resulting from the logging operation shall be left in any roads, fields, branches, or across boundary or cutting lines.
- 3) All existing or constructed roads shall be left in as good as or better condition after use, as was prior to use. If weather conditions are such that excessive rutting or other damage is occurring to any areas of the property up to and including the Sale Area or Access road, Forest Land Resource Consultants, LLC, Agent for the Seller, may suspend logging operations if appropriate measures are not taken to limit the damage.
- 4) All trash such as, but not limited to, oil cans, paper bags, sandwich wrappers, bottles, food cans, etc. are to be carried off on a daily basis.
- 5) Forest Land Resource Consultant, LLC, Agent of the Seller, is to be notified when logging operations begin and at least three (3) days prior to completion.
- 6) **INDEMNITY CLAUSE:** The Buyer shall indemnify and hold harmless the Seller from any and all liability for loss to any person whomsoever for property damage, personal injury, death, or otherwise during activities incident to or related to this contract, including any fines resulting from noncompliance with Best Management Practices. The Buyer will carry sufficient insurance and liability insurance to protect Seller from any liability whatsoever, and will furnish evidence of such insurance upon request of Seller and/or his Agent.
- 7) The draining of oil, grease, or hydraulic oil onto the ground on this property is expressly forbidden. Drainage of such petroleum products should be into adequate containers and disposed of properly.
- 8) No line or corner witness trees are to be cut, and any destroyed property corner shall be immediately restored at the Buyer's expense.
- 9) The Buyer shall be liable for compliance with Forest Practices Guidelines Related To Water Quality (Best Management Practices): Statue 15 NCAC, Subchapter 1J, Sections .0101 thru .0209.
- 10) The Buyer shall at closing post a \$3,000.00 performance bond with Forest Land Resource Consultants, LLC. The bond shall be forfeitable in part or in whole upon the basis of a final inspection by the Agent. The amount of the bond is not intended to limit what the agent may determine to be the maximum damage that may have been incurred or inflicted.

Attachments

Volume summary sheets, timber sale map, and sale location map.

Terry Parrott Summary Report

Tract: Parrott
Compartment: 1

Cruised Acres: 20
of Plots: 49

Plot Type: F
Plot Size or BAF: 10

Product	Trees	Tons	MBF	Cords	Cunits	Topwood		BA	SPA	DBH	Ht
						Tons					
Pine Sawtimber	943	946	133	358	277	81		49	47	13.5	3.0
Pine Pulpwood	200	49	0	19	14	0		4	10	8.0	5.8
Total:	1,143	996	133	377	290	81		52	57	12.5	3.5

Product	Trees	Tons	MBF	Cords	Cunits	Topwood		BA	SPA	DBH	Ht
						Tons					
Hardwood Pulpwood	584	246	0	89	63	0		17	29	10.0	6.1
Yellow Poplar	94	135	21	49	38	19		7	5	16.8	2.6
Palletwood	143	92	9	32	24	6		5	7	11.4	2.3
White Oak	94	86	11	30	23	21		6	5	15.5	1.6
Sweetgum	90	80	8	28	22	17		6	4	15.2	1.9
Red Oak	37	44	6	15	12	10		3	2	17.3	1.8
Maple	16	10	1	4	3	5		1	1	16.0	1.0
Total:	1,057	694	57	247	185	77		45	53	12.1	4.3

Grand Total: **2,200** **1,689** **190** **624** **475** **158** **97** **110** **12.3** **3.9**

Pine Sawtimber

DBH	Trees	Totals				Per Acre					Per Tree			
		Tons	MBF	Cunits	Topwood	Trees	Tons	MBF	Cun.	Top	Tons	BF	Cun	Top
10	184	84	8	25	30	9.2	4.2	0.4	1.3	1.5	0.5	45	0.1	0.2
12	249	192	23	57	26	12.4	9.6	1.1	2.8	1.3	0.8	91	0.2	0.1
14	249	264	36	77	16	12.4	13.2	1.8	3.9	0.8	1.1	146	0.3	0.1
16	167	238	36	69	7	8.4	11.9	1.8	3.5	0.4	1.4	216	0.4	0.0
18	73	128	22	37	2	3.7	6.4	1.1	1.8	0.1	1.7	293	0.5	0.0
20	16	31	6	9	0	0.8	1.5	0.3	0.4	0.0	1.9	348	0.5	0.0
24	4	11	2	3	0	0.2	0.6	0.1	0.2	0.0	2.7	565	0.8	0.0
13.5	943	946	133	277	81	47.1	47.3	6.6	13.8	4.1	1.0	141	0.3	0.1

Conversion Factors

Tons/MBF: 7.12
Tons/Cunit: 3.42
Tons/Cord: 2.64
Cunits/MBF: 2.08

Logrule & FC: S 78
Avg. Height: 3.0

Yellow Poplar

DBH	Trees	Totals		Cunits		Per Acre					Per Tree			
		Tons	MBF	Topwood	Trees	Tons	MBF	Cun.	Top	Tons	BF	Cun	Top	
12	4	3	0	1	0	0.2	0.2	0.0	0.0	0.0	0.7	84	0.2	0.0
14	24	23	3	6	3	1.2	1.2	0.2	0.3	0.1	1.0	127	0.3	0.1
16	20	26	4	7	4	1.0	1.3	0.2	0.4	0.2	1.3	189	0.4	0.2
18	20	37	6	10	4	1.0	1.9	0.3	0.5	0.2	1.8	284	0.5	0.2
20	24	45	8	13	8	1.2	2.3	0.4	0.6	0.4	1.8	314	0.5	0.3
16.8	94	135	21	38	19	4.7	6.8	1.0	1.9	0.9	1.4	222	0.4	0.2

Conversion Factors

Tons/MBF: 6.49
 Tons/Cunit: 3.58
 Tons/Cord: 2.75
 Cunits/MBF: 1.81

Logrule && FC: S 78
Avg. Height: 2.6

White Oak

DBH	Trees	Totals		Cunits		Per Acre					Per Tree			
		Tons	MBF	Topwood	Trees	Tons	MBF	Cun.	Top	Tons	BF	Cun	Top	
14	41	28	3	7	8	2.0	1.4	0.2	0.4	0.4	0.7	84	0.2	0.2
16	41	42	5	11	9	2.0	2.1	0.3	0.6	0.5	1.0	134	0.3	0.2
18	8	9	1	2	2	0.4	0.5	0.1	0.1	0.1	1.2	160	0.3	0.3
20	4	7	1	2	1	0.2	0.4	0.1	0.1	0.1	1.8	258	0.5	0.3
15.5	94	86	11	23	21	4.7	4.3	0.6	1.1	1.0	0.9	120	0.2	0.2

Conversion Factors

Tons/MBF: 7.68
 Tons/Cunit: 3.79
 Tons/Cord: 2.90
 Cunits/MBF: 2.02

Logrule && FC: S 76
Avg. Height: 1.6

Sweetgum

DBH	Trees	Totals		Cunits		Per Acre					Per Tree			
		Tons	MBF	Topwood	Trees	Tons	MBF	Cun.	Top	Tons	BF	Cun	Top	
14	49	38	3	11	8	2.4	1.9	0.2	0.5	0.4	0.8	71	0.2	0.2
16	29	29	3	8	6	1.4	1.4	0.2	0.4	0.3	1.0	112	0.3	0.2
18	12	13	2	4	4	0.6	0.7	0.1	0.2	0.2	1.1	143	0.3	0.3
15.2	90	80	8	22	17	4.5	4.0	0.4	1.1	0.9	0.9	94	0.2	0.2

Conversion Factors

Tons/MBF: 9.50
 Tons/Cunit: 3.60
 Tons/Cord: 2.87
 Cunits/MBF: 2.64

Logrule && FC: D 78
Avg. Height: 1.9

Red Oak

DBH	Trees	Totals		Per Acre							Per Tree			
		Tons	MBF	Cunits	Topwood	Trees	Tons	MBF	Cun.	Top	Tons	BF	Cun	Top
14	8	7	1	2	1	0.4	0.4	0.0	0.1	0.1	0.9	107	0.2	0.1
16	16	19	3	5	3	0.8	1.0	0.1	0.3	0.2	1.2	154	0.3	0.2
18	4	4	0	1	1	0.2	0.2	0.0	0.0	0.1	0.9	119	0.2	0.3
20	4	4	1	1	2	0.2	0.2	0.0	0.1	0.1	1.1	151	0.3	0.4
26	4	10	2	3	2	0.2	0.5	0.1	0.1	0.1	2.5	371	0.7	0.5
17.3	37	44	6	12	10	1.8	2.2	0.3	0.6	0.5	1.2	163	0.3	0.3

Conversion Factors

Tons/MBF: 7.41
 Tons/Cunit: 3.78
 Tons/Cord: 2.90
 Cunits/MBF: 1.96

Logrule && FC: S 76
Avg. Height: 1.8

Palletwood

DBH	Trees	Totals		Per Acre							Per Tree			
		Tons	MBF	Cunits	Topwood	Trees	Tons	MBF	Cun.	Top	Tons	BF	Cun	Top
10	57	26	2	7	1	2.9	1.3	0.1	0.3	0.1	0.4	40	0.1	0.0
12	73	54	6	14	3	3.7	2.7	0.3	0.7	0.2	0.7	77	0.2	0.0
14	12	12	1	3	1	0.6	0.6	0.1	0.2	0.1	1.0	121	0.3	0.1
11.4	143	92	9	24	6	7.1	4.6	0.5	1.2	0.3	0.6	66	0.2	0.0

Conversion Factors

Tons/MBF: 9.79
 Tons/Cunit: 3.81
 Tons/Cord: 2.87
 Cunits/MBF: 2.57

Logrule && FC: S 76
Avg. Height: 2.3

Maple

DBH	Trees	Totals		Per Acre							Per Tree			
		Tons	MBF	Cunits	Topwood	Trees	Tons	MBF	Cun.	Top	Tons	BF	Cun	Top
14	4	2	0	1	1	0.2	0.1	0.0	0.0	0.0	0.5	65	0.1	0.2
16	8	5	1	1	2	0.4	0.2	0.0	0.1	0.1	0.6	90	0.2	0.3
18	4	3	0	1	1	0.2	0.1	0.0	0.0	0.1	0.7	119	0.2	0.3
16.0	16	10	1	3	5	0.8	0.5	0.1	0.1	0.2	0.6	91	0.2	0.3

Conversion Factors



Tons/MBF: 6.47
 Tons/Cunit: 3.54
 Tons/Cord: 2.75
 Cunits/MBF: 1.83

Logrule && FC: S 76
Avg. Height: 1.0

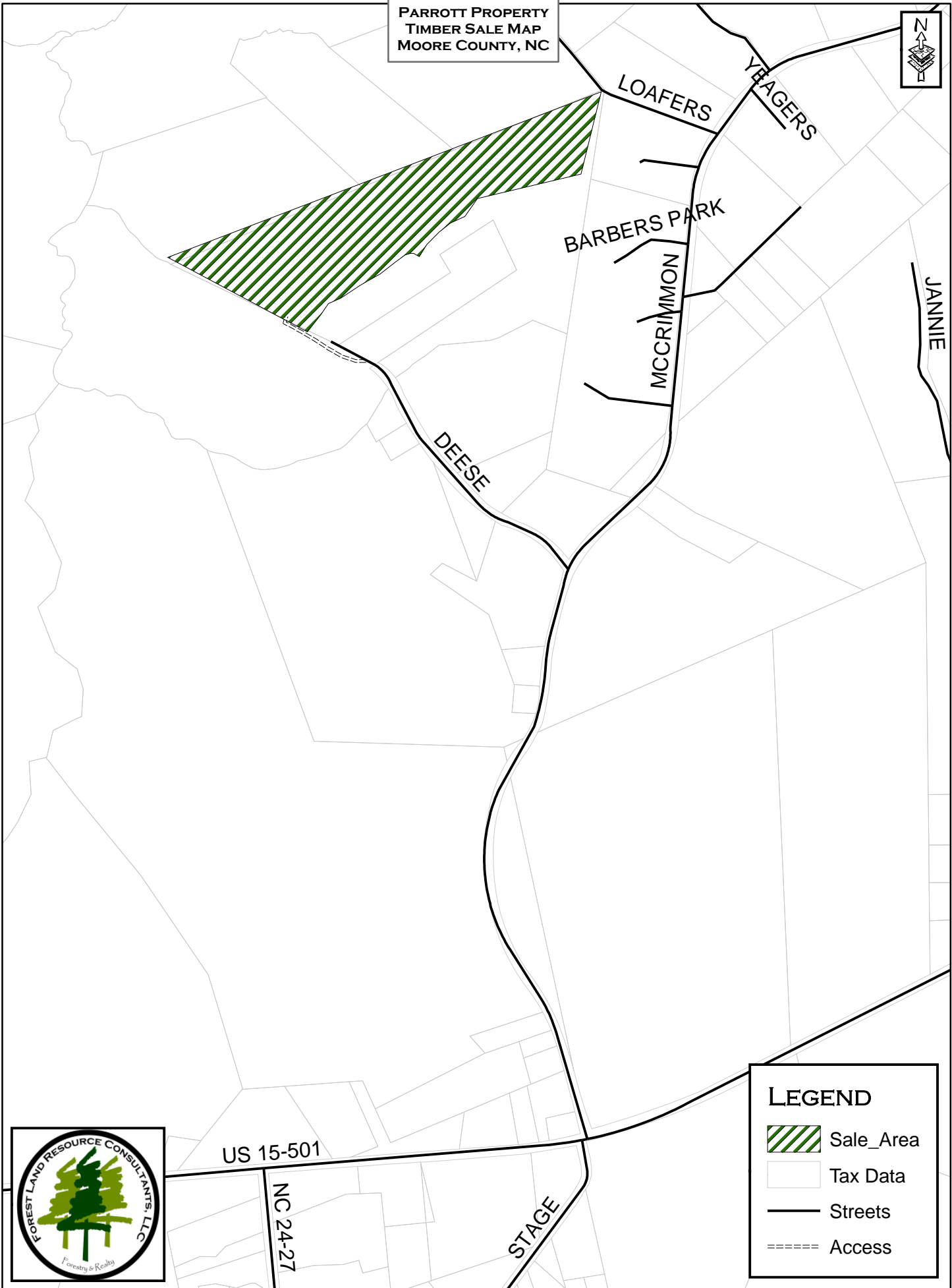
PARROTT PROPERTY
TIMBER SALE MAP
MOORE COUNTY, NC



LEGEND

-  Sale_Area
-  Tax Data
-  Streets
-  Access



PARROTT PROPERTY
 TIMBER SALE MAP
 MOORE COUNTY, NC

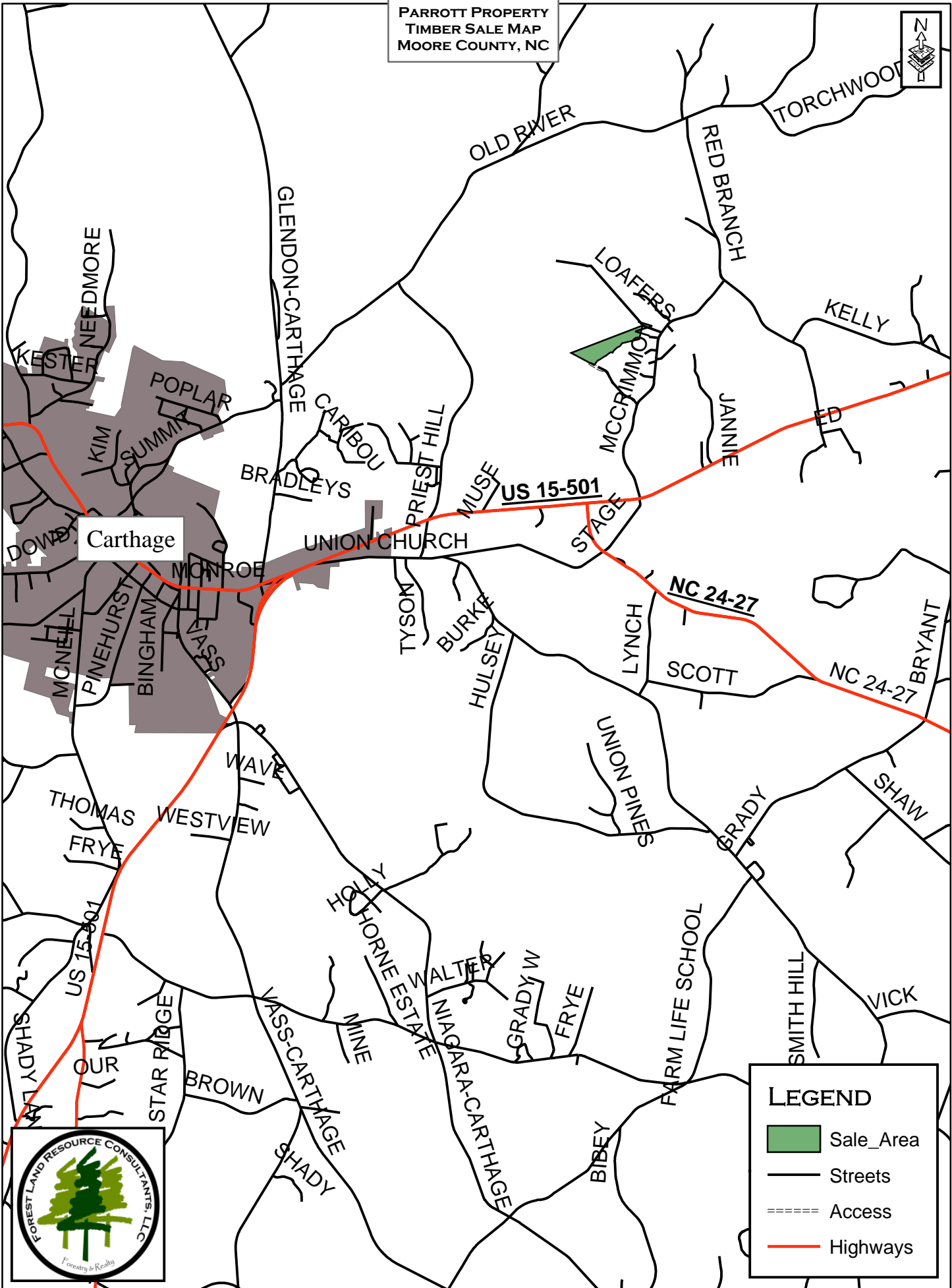

Carthage

US 15-501

NC 24-27

NC 24-27

US 15-501

LEGEND

- Sale_Area
- Streets
- Access
- Highways

