



# Forest Land Resource Consultants, LLC

## Consulting Forestry & Real Estate

P.O. Box 7 • West End, NC 27376  
(910) 673-0001 Office • (910) 673-3233 Fax • [www.forestlandrc.com](http://www.forestlandrc.com)

### INVITATION TO BID ON STANDING TIMBER

owned by

*“Mr. & Mrs. Yates Hussey”*

Randolph County, NC

34 wooded acres, more or less

**SALE DATE: 12:00 P.M. – 10/01/2009**

### **Timber Volumes**

<b><u>Product</u></b>	<b><u>Volume</u></b>
Pine Sawtimber	10,000 bf
Pine Pulpwood	11 cords
Red Oak	36,000 bf
Yellow Poplar Logs	55,000 bf
White Oak	64,000 bf
Hickory	13,000 bf
Sweetgum	11,000 bf
Hardwood Palletwood	529 tons
Hardwood Pulpwood	832 tons

A timber cruise using tenth acre fixed plots was performed to determine the timber volumes; however, timber volumes are given for information only and are not guaranteed. Cruise lines were spaced 3 chains apart and 2 chains between plots. The timber sale area was measured using GPS. The above pulpwood volumes include top wood.

### **Tract Location**

This tract is located on the Moore-Randolph County line off N. Howards Mill Road, in Randolph County. Refer to the attached maps for better detail.

### **Description of Timber & Land**

All merchantable timber of every sort and kind contained within the designated sale area is offered for sale on a clear-cut basis, with the exception of the area in the South Eastern corner that is marked as a buffer strip. Within the buffer strip, only the Blue painted trees are to be harvested. The timber consists of a mixture of Red and White oak, Poplar, Hickory, and Gum.

The property lines have been delineated with Pink Glo Ribbon, and the SMZ's are not painted.

**Walter E. Thomas, RF:** Registered Forester #409 • Real Estate Broker #47789 • [walter@forestlandrc.com](mailto:walter@forestlandrc.com)

**Matthew L. Wimberly, RF, ACF:** Registered Forester #1407 • Real Estate Broker #254183 • Certified Burner #566 • [wimberly@forestlandrc.com](mailto:wimberly@forestlandrc.com)

---

Land Sales & Acquisitions, Forest Management, Timber Investment Analysis, Timber Marketing, Timber Appraisals,  
Present Use Plans, GIS/GPS Mapping, Prescribed Burning, Casualty and Non-casualty Losses

### Access

Access for logging can be initiated from the Jabo Hussey Road. The location of Logging Decks will be in coordination with Forest Land Resource Consultants, and the Landowner.

### Bids

All bids for this sale will be received on a “**lump sum basis only**”. Bids will be accepted and disclosed at **12:00 P.M. Thursday, October 1, 2009** in my office in Seven Lakes. Please contact our office for directions. All interested buyers who would like to submit a bid in person are to meet at the office on the day of the sale. If you cannot be present for the sale, you have until 11:00 a.m. the same day to place your bid by mail, fax (910) 673-3233, office (910) 673-0001 or by cell phone (910) 639-0124.

The owner reserves forty-eight (48) hours to determine the acceptance or denial of any or all bids.

### Conditions of Sale

- 1) The Buyer will have twenty-four (24) months from the date of execution of the timber deed to cut and remove the timber.
- 2) No trees, laps, limbs, or other debris resulting from the logging operation shall be left in any roads, fields, branches, or across boundary or cutting lines.
- 3) All existing or constructed roads shall be left in as good as or better condition after use, as was prior to use. If weather conditions are such that excessive rutting or other damage is occurring to any areas of the property up to and including the Sale Area or Access road, Forest Land Resource Consultants, LLC, Agent for the Seller, may suspend logging operations if appropriate measures are not taken to limit the damage.
- 4) All trash such as, but not limited to, oil cans, paper bags, sandwich wrappers, bottles, food cans, etc. are to be carried off on a daily basis.
- 5) Forest Land Resource Consultant, LLC, Agent of the Seller, is to be notified when logging operations begin and at least three (3) days prior to completion.
- 6) **INDEMNITY CLAUSE:** The Buyer shall indemnify and hold harmless the Seller from any and all liability for loss to any person whomsoever for property damage, personal injury, death, or otherwise during activities incident to or related to this contract, including any fines resulting from noncompliance with Best Management Practices. The Buyer will carry sufficient insurance and liability insurance to protect Seller from any liability whatsoever, and will furnish evidence of such insurance upon request of Seller and/or his Agent.
- 7) The draining of oil, grease, or hydraulic oil onto the ground on this property is expressly forbidden. Drainage of such petroleum products should be into adequate containers and disposed of properly.
- 8) No line or corner witness trees are to be cut, and any destroyed property corner shall be immediately restored at the Buyer's expense.
- 9) The Buyer shall be liable for compliance with Forest Practices Guidelines Related To Water Quality (Best Management Practices): Statue 15 NCAC, Subchapter 1J, Sections .0101 thru .0209.
- 10) The Buyer shall at closing post a \$3,000.00 performance bond with Forest Land Resource Consultants, LLC. The bond shall be forfeitable in part or in whole upon the basis of a final inspection by the Agent. The amount of the bond is not intended to limit what the agent may determine to be the maximum damage that may have been incurred or inflicted.

## Yates & Carmen Hussey

### Summary Report

11-Sep-09

*Tract: Rand Co.*  
*Compartment: 1*  
*Stand: 1*

*Cruised Acres: 32*  
*# of Plots: 55*

*Plot Type: F*  
*Plot Size or BAF: 10*

<i>Product</i>	<i>Trees</i>	<i>Tons</i>	<i>MBF</i>	<i>Cords</i>	<i>Cunits</i>	<i>Topwood</i>		<i>BA</i>	<i>SPA</i>	<i>DBH</i>	<i>Ht</i>
						<i>Tons</i>					
<i>Pine Sawtimber</i>	105	77	10	29	23	11		3	3	12.1	2.7
<b>Total:</b>	<b>105</b>	<b>77</b>	<b>10</b>	<b>29</b>	<b>23</b>	<b>11</b>		<b>3</b>	<b>3</b>	<b>12.1</b>	<b>2.7</b>

<i>Product</i>	<i>Trees</i>	<i>Tons</i>	<i>MBF</i>	<i>Cords</i>	<i>Cunits</i>	<i>Topwood</i>		<i>BA</i>	<i>SPA</i>	<i>DBH</i>	<i>Ht</i>
						<i>Tons</i>					
<i>Hardwood Pulpwood</i>	1,583	555	0	202	143	0		22	49	8.9	6.5
<i>Palletwood</i>	780	529	53	184	139	27		18	24	11.5	2.5
<i>White Oak</i>	436	476	62	164	126	93		19	14	15.8	1.9
<i>Yellow Poplar</i>	297	355	53	129	99	53		13	9	15.7	2.4
<i>Red Oak</i>	221	257	34	88	68	53		11	7	16.6	1.8
<i>Hickory</i>	157	131	13	45	37	32		6	5	15.1	1.7
<i>Sweetgum</i>	122	112	11	39	31	18		4	4	14.4	2.1
<b>Total:</b>	<b>3,596</b>	<b>2,413</b>	<b>227</b>	<b>852</b>	<b>641</b>	<b>277</b>		<b>92</b>	<b>112</b>	<b>11.8</b>	<b>4.1</b>

**Grand Total:**      **3,700**      **2,490**      **237**      **881**      **664**      **288**      **95**      **116**      **11.8**      **4.0**

## Yates & Carmen Hussey 100% Buffer

### Summary Report

11-Sep-09

<i>Product</i>	<i>Trees</i>	<i>Tons</i>	<i>MBF</i>	<i>Cords</i>	<i>Cunits</i>	<i>Topwood</i>		<i>BA</i>	<i>SPA</i>	<i>DBH</i>	<i>Ht</i>
						<i>Tons</i>					
<i>White Oak</i>	14	15	2	5	4	4		22	14	17.0	1.6
<i>Red Oak</i>	11	15	2	5	4	3		22	11	18.7	1.8
<i>Yellow Poplar</i>	11	13	2	5	4	3		18	11	16.9	2.1
<i>Sweetgum</i>	3	3	0	1	1	0		4	3	14.7	2.5
<b>Total:</b>	<b>39</b>	<b>47</b>	<b>7</b>	<b>16</b>	<b>13</b>	<b>10</b>		<b>65</b>	<b>39</b>	<b>17.3</b>	<b>1.9</b>

**Grand Total:**      **39**      **47**      **7**      **16**      **13**      **10**      **65**      **39**      **17.3**      **1.9**

**Yates & Carmen Hussey  
Sawtimber Summary Report by DBH**

11-Sep-

09

**Tract:** Rand Co.  
**Compartment:** 1  
**Stand:** 1

**Cruised Acres:** 32  
**# of Plots:** 55

**Plot Type:** F  
**Plot Size or BAF:** 10

**Pine Sawtimber**

DBH	Trees	Totals		Cunits		Per Acre					Per Tree			
		Tons	MBF	Topwood	Trees	Tons	MBF	Cun.	Top	Tons	BF	Cun	Top	
10	41	16	2	5	6	1.3	0.5	0.1	0.1	0.2	0.4	42	0.1	0.1
12	35	28	3	8	4	1.1	0.9	0.1	0.3	0.1	0.8	94	0.2	0.1
14	12	11	2	3	1	0.4	0.3	0.0	0.1	0.0	0.9	137	0.3	0.1
16	17	22	3	6	1	0.5	0.7	0.1	0.2	0.0	1.3	198	0.4	0.0
12.1	105	77	10	23	11	3.3	2.4	0.3	0.7	0.3	0.7	96	0.2	0.1

**Conversion Factors**

Tons/MBF: 7.67  
Tons/Cunit: 3.41  
Tons/Cord: 2.64  
Cunits/MBF: 2.25

**Logrule && FC:** S 78  
**Avg. Height:** 2.7

**Yellow Poplar**

DBH	Trees	Totals		Cunits		Per Acre					Per Tree			
		Tons	MBF	Topwood	Trees	Tons	MBF	Cun.	Top	Tons	BF	Cun	Top	
12	23	10	1	3	4	0.7	0.3	0.0	0.1	0.1	0.4	54	0.1	0.2
14	116	104	14	29	15	3.6	3.3	0.4	0.9	0.5	0.9	120	0.2	0.1
16	76	98	14	27	13	2.4	3.1	0.4	0.8	0.4	1.3	190	0.4	0.2
18	52	83	13	23	13	1.6	2.6	0.4	0.7	0.4	1.6	254	0.4	0.2
20	23	45	8	13	7	0.7	1.4	0.2	0.4	0.2	1.9	332	0.5	0.3
22	6	15	3	4	2	0.2	0.5	0.1	0.1	0.1	2.6	460	0.7	0.4
15.7	297	355	53	99	53	9.3	11.1	1.7	3.1	1.7	1.2	180	0.3	0.2

**Conversion Factors**

Tons/MBF: 6.65  
Tons/Cunit: 3.59  
Tons/Cord: 2.75  
Cunits/MBF: 1.85

**Logrule && FC:** S 78  
**Avg. Height:** 2.4

**White Oak**

DBH	Trees	Totals		Cunits		Per Acre					Per Tree			
		Tons	MBF	Topwood	Trees	Tons	MBF	Cun.	Top	Tons	BF	Cun	Top	
12	6	2	0	1	1	0.2	0.1	0.0	0.0	0.0	0.4	44	0.1	0.2
14	169	133	16	35	28	5.3	4.2	0.5	1.1	0.9	0.8	96	0.2	0.2
16	157	182	24	48	32	4.9	5.7	0.7	1.5	1.0	1.2	151	0.3	0.2
18	76	107	15	28	21	2.4	3.3	0.5	0.9	0.7	1.4	195	0.4	0.3
20	17	29	4	8	6	0.5	0.9	0.1	0.2	0.2	1.7	236	0.4	0.3
22	12	22	3	6	5	0.4	0.7	0.1	0.2	0.1	1.9	282	0.5	0.4
15.8	436	476	62	126	93	13.6	14.9	2.0	3.9	2.9	1.1	143	0.3	0.2

**Conversion Factors**

Tons/MBF: 7.62  
Tons/Cunit: 3.79  
Tons/Cord: 2.90  
Cunits/MBF: 2.01

**Logrule && FC:** S 76  
**Avg. Height:** 1.9

**Sweetgum**

DBH	Trees	Totals		Per Acre							Per Tree			
		Tons	MBF	Cunits	Topwood	Trees	Tons	MBF	Cun.	Top	Tons	BF	Cun	Top
12	6	3	0	1	1	0.2	0.1	0.0	0.0	0.0	0.5	36	0.1	0.1
14	87	73	7	20	13	2.7	2.3	0.2	0.6	0.4	0.8	75	0.2	0.1
16	29	36	4	10	5	0.9	1.1	0.1	0.3	0.2	1.2	132	0.3	0.2
14.4	122	112	11	31	18	3.8	3.5	0.3	1.0	0.6	0.9	87	0.3	0.2

**Conversion Factors**

Tons/MBF: 10.53  
 Tons/Cunit: 3.62  
 Tons/Cord: 2.87  
 Cunits/MBF: 2.91

Logrule && FC: D 78  
 Avg. Height: 2.1

**Red Oak**

DBH	Trees	Totals		Per Acre							Per Tree			
		Tons	MBF	Cunits	Topwood	Trees	Tons	MBF	Cun.	Top	Tons	BF	Cun	Top
12	12	4	1	1	2	0.4	0.1	0.0	0.0	0.1	0.4	44	0.1	0.2
14	76	63	8	17	12	2.4	2.0	0.2	0.5	0.4	0.8	102	0.2	0.2
16	70	80	10	21	15	2.2	2.5	0.3	0.7	0.5	1.1	148	0.3	0.2
18	29	35	5	9	9	0.9	1.1	0.2	0.3	0.3	1.2	166	0.3	0.3
20	6	10	2	3	2	0.2	0.3	0.0	0.1	0.1	1.8	258	0.5	0.3
22	6	13	2	3	2	0.2	0.4	0.1	0.1	0.1	2.2	322	0.6	0.4
24	12	30	4	8	5	0.4	0.9	0.1	0.2	0.2	2.6	386	0.7	0.5
26	12	21	3	6	6	0.4	0.7	0.1	0.2	0.2	1.8	271	0.5	0.5
16.6	221	257	34	68	53	6.9	8.0	1.1	2.1	1.6	1.2	155	0.3	0.2

**Conversion Factors**

Tons/MBF: 7.47  
 Tons/Cunit: 3.78  
 Tons/Cord: 2.90  
 Cunits/MBF: 1.98

Logrule && FC: S 76  
 Avg. Height: 1.8

**Palletwood**

DBH	Trees	Totals		Per Acre							Per Tree			
		Tons	MBF	Cunits	Topwood	Trees	Tons	MBF	Cun.	Top	Tons	BF	Cun	Top
10	262	127	11	33	3	8.2	4.0	0.3	1.0	0.1	0.5	41	0.1	0.0
12	483	369	38	97	19	15.1	11.5	1.2	3.0	0.6	0.8	79	0.2	0.0
14	23	24	3	6	2	0.7	0.8	0.1	0.2	0.1	1.0	118	0.3	0.1
16	6	4	1	1	2	0.2	0.1	0.0	0.0	0.1	0.7	90	0.2	0.3
18	6	5	1	1	2	0.2	0.2	0.0	0.0	0.1	0.9	119	0.2	0.3
11.5	780	529	53	139	27	24.4	16.5	1.6	4.3	0.9	0.7	68	0.2	0.0

**Conversion Factors**

Tons/MBF: 10.02  
 Tons/Cunit: 3.81  
 Tons/Cord: 2.87  
 Cunits/MBF: 2.63

Logrule && FC: S 76  
 Avg. Height: 2.5

**Hickory**

DBH	Trees	Totals		Per Acre							Per Tree			
		Tons	MBF	Cunits	Topwood	Trees	Tons	MBF	Cun.	Top	Tons	BF	Cun	Top
14	93	62	5	17	17	2.9	1.9	0.2	0.5	0.5	0.7	59	0.2	0.2
16	41	40	4	11	9	1.3	1.2	0.1	0.3	0.3	1.0	101	0.3	0.2
18	23	30	4	8	6	0.7	0.9	0.1	0.3	0.2	1.3	153	0.4	0.3
15.1	157	131	13	37	32	4.9	4.1	0.4	1.1	1.0	0.8	84	0.2	0.2

**Yates & Carmen Hussey 100% Buffer  
Sawtimber Summary Report by DBH**

11-Sep-

09

Tract: Rand Co.  
Compartment: 1  
Stand: 1

Cruised Acres: 1  
# of Plots: 1

Plot Type: F  
Plot Size or BAF: 1

**Yellow Poplar**

DBH	Trees	Totals		Cunits		Per Acre					Per Tree			
		Tons	MBF	Topwood	Trees	Tons	MBF	Cun.	Top	Tons	BF	Cun	Top	
14	4	3	0	1	1	4.0	3.2	0.4	0.9	0.6	0.8	111	0.2	0.1
16	1	1	0	0	0	1.0	1.0	0.2	0.3	0.2	1.0	161	0.3	0.2
18	3	5	1	1	1	3.0	4.9	0.8	1.4	0.7	1.6	259	0.5	0.2
20	3	4	1	1	1	3.0	4.0	0.7	1.1	1.1	1.3	237	0.4	0.4
16.9	11	13	2	4	3	11.0	13.1	2.1	3.7	2.6	1.2	190	0.3	0.2

**White Oak**

DBH	Trees	Totals		Cunits		Per Acre					Per Tree			
		Tons	MBF	Topwood	Trees	Tons	MBF	Cun.	Top	Tons	BF	Cun	Top	
14	2	2	0	0	0	2.0	1.6	0.2	0.4	0.3	0.8	96	0.2	0.2
16	5	5	1	1	1	5.0	4.6	0.6	1.2	1.2	0.9	120	0.2	0.2
18	5	6	1	2	1	5.0	6.1	0.8	1.6	1.5	1.2	168	0.3	0.3
20	2	3	0	1	1	2.0	3.2	0.5	0.9	0.7	1.6	231	0.4	0.3
17.0	14	15	2	4	4	14.0	15.5	2.1	4.1	3.7	1.1	150	0.3	0.3

**Sweetgum**

DBH	Trees	Totals		Cunits		Per Acre					Per Tree			
		Tons	MBF	Topwood	Trees	Tons	MBF	Cun.	Top	Tons	BF	Cun	Top	
14	2	2	0	1	0	2.0	2.0	0.2	0.5	0.2	1.0	84	0.3	0.1
16	1	1	0	0	0	1.0	1.2	0.1	0.3	0.2	1.2	132	0.3	0.2
14.7	3	3	0	1	0	3.0	3.2	0.3	0.9	0.4	1.1	100	0.3	0.1

**Red Oak**

DBH	Trees	Totals		Cunits		Per Acre					Per Tree			
		Tons	MBF	Topwood	Trees	Tons	MBF	Cun.	Top	Tons	BF	Cun	Top	
14	1	1	0	0	0	1.0	0.7	0.1	0.2	0.2	0.7	86	0.2	0.2
16	4	5	1	1	1	4.0	4.7	0.6	1.2	0.8	1.2	151	0.3	0.2
18	3	4	1	1	1	3.0	3.8	0.5	1.0	0.9	1.3	174	0.3	0.3
20	1	2	0	1	0	1.0	2.1	0.3	0.6	0.3	2.1	300	0.6	0.3
26	1	2	0	0	1	1.0	1.8	0.3	0.5	0.5	1.8	271	0.5	0.5
28	1	2	0	1	1	1.0	2.1	0.3	0.6	0.6	2.1	318	0.6	0.6
18.7	11	15	2	4	3	11.0	15.2	2.1	4.0	3.3	1.4	191	0.4	0.3

# YATES & CARMEN HUSSEY TIMBER SALE MAP

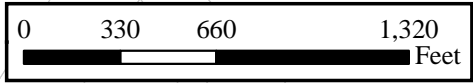
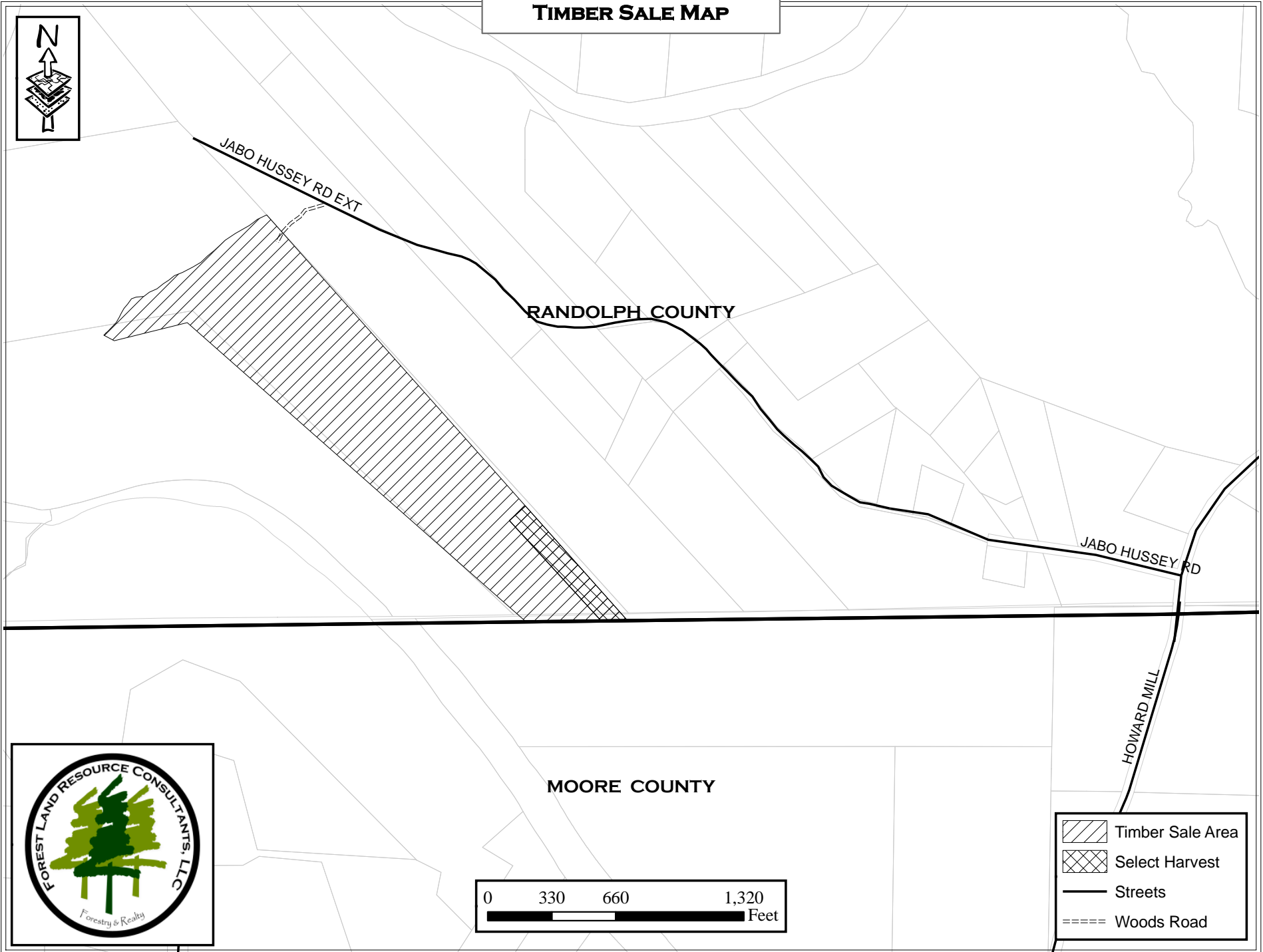

-  Timber Sale Area
-  Select Harvest
-  Streets
-  Woods Road

**YATES & CARMEN HUSSEY  
TIMBER SALE LOCATION MAP**

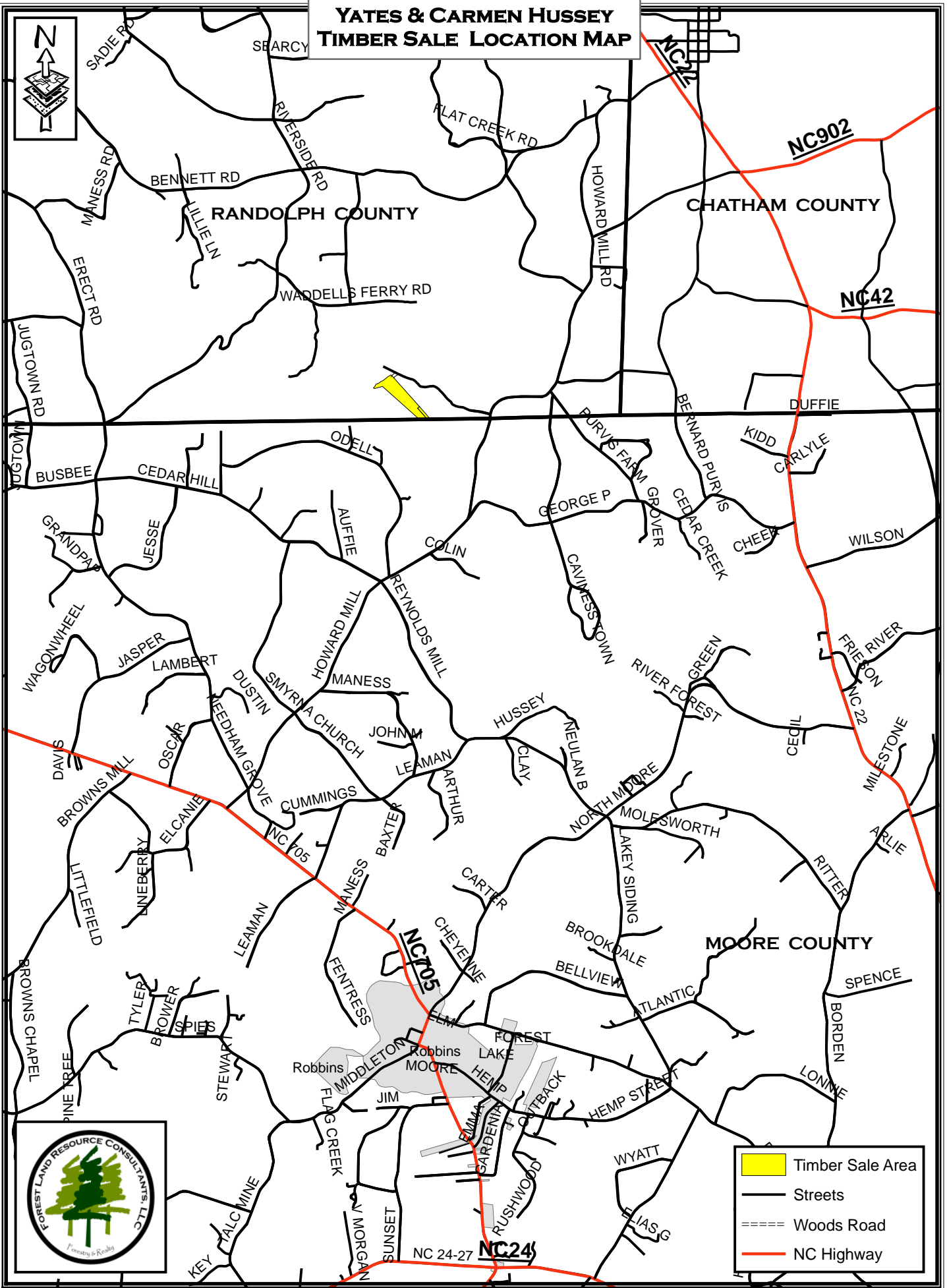
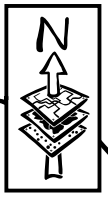

	Timber Sale Area
	Streets
	Woods Road
	NC Highway